



# Manual - ValkTwinRail



		page
Table of contents		1
Disclaimer		2
Mounting ValkRailBracket	ValkRailBracket Twin	A1
Mounting ValkDriveShaft	ValkDriveShaft	B1
Push-Pull Tubes	Push-Pull Tubes	C1 - 2
Push Rod Assembly	Push Rods - Middle Section	D1 - 2
Push Rod Assembly	Push Rods - First Row	E1 - 2
Mounting of Push Rods on the Vent	Push Rods on the Vent	F1
Mounting of ValkStabiMax on the Clamp	ValkStabiMax on the Clamp	G1

You have chosen a ValkTwinRail system from Van der Valk horti systems. This is a standard manual, for specific installation drawings, see project drawings and quotation supplied separately.

- \* This manual is not project specific.
- \* This manual is not legally binding.
- \* No right may be derived from this installation manual.
- \* Consult the driverack and motor supplier manual for installation of their products.



If you scan or click this QR-code you will be linked to a youtube movie of the ValkTwinRail with additional explanation.



41.22.51    Ø27 mm

41.22.52    Ø32 mm



55.40.--    M8x--  
(Height tube + 15 mm)



55.40.05    M8



53.55.38    M8

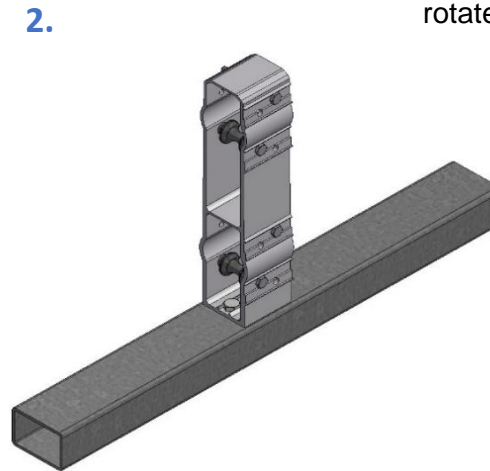
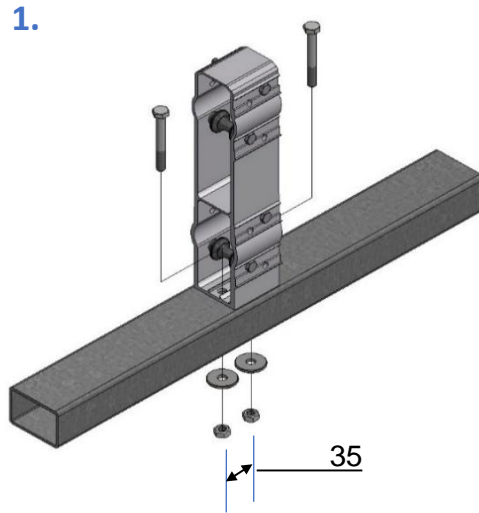

Note: Rolls must be able to rotate without friction.

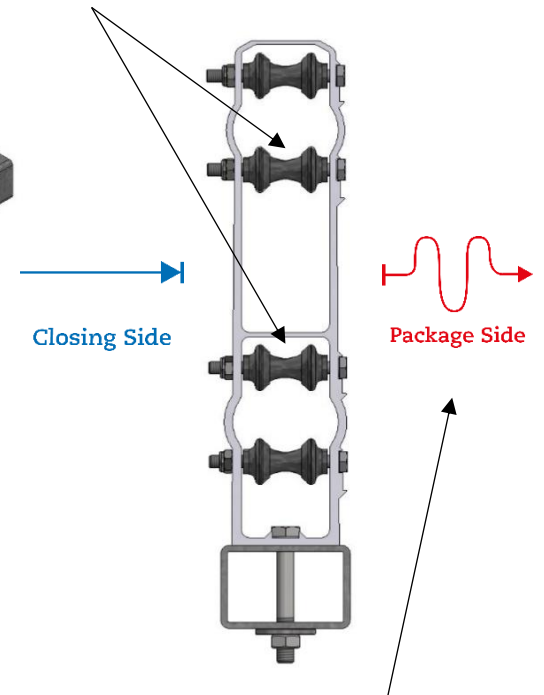

Note: Mount the rail brackets with the head sides of the bolts at the package side of the screen.

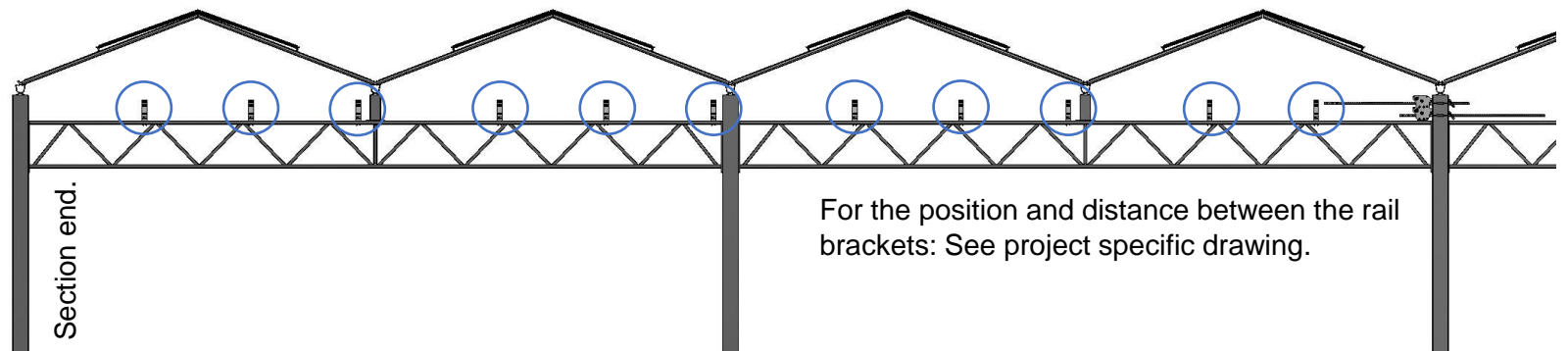

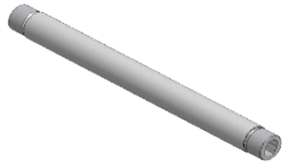

522.03.03.-----  
Type A, Rack to rack, 5/4" x 2,5 mm

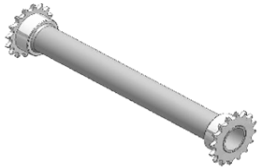

522.15.15.-----  
Type B, Motor shaft, 5/4" x 2,5 mm

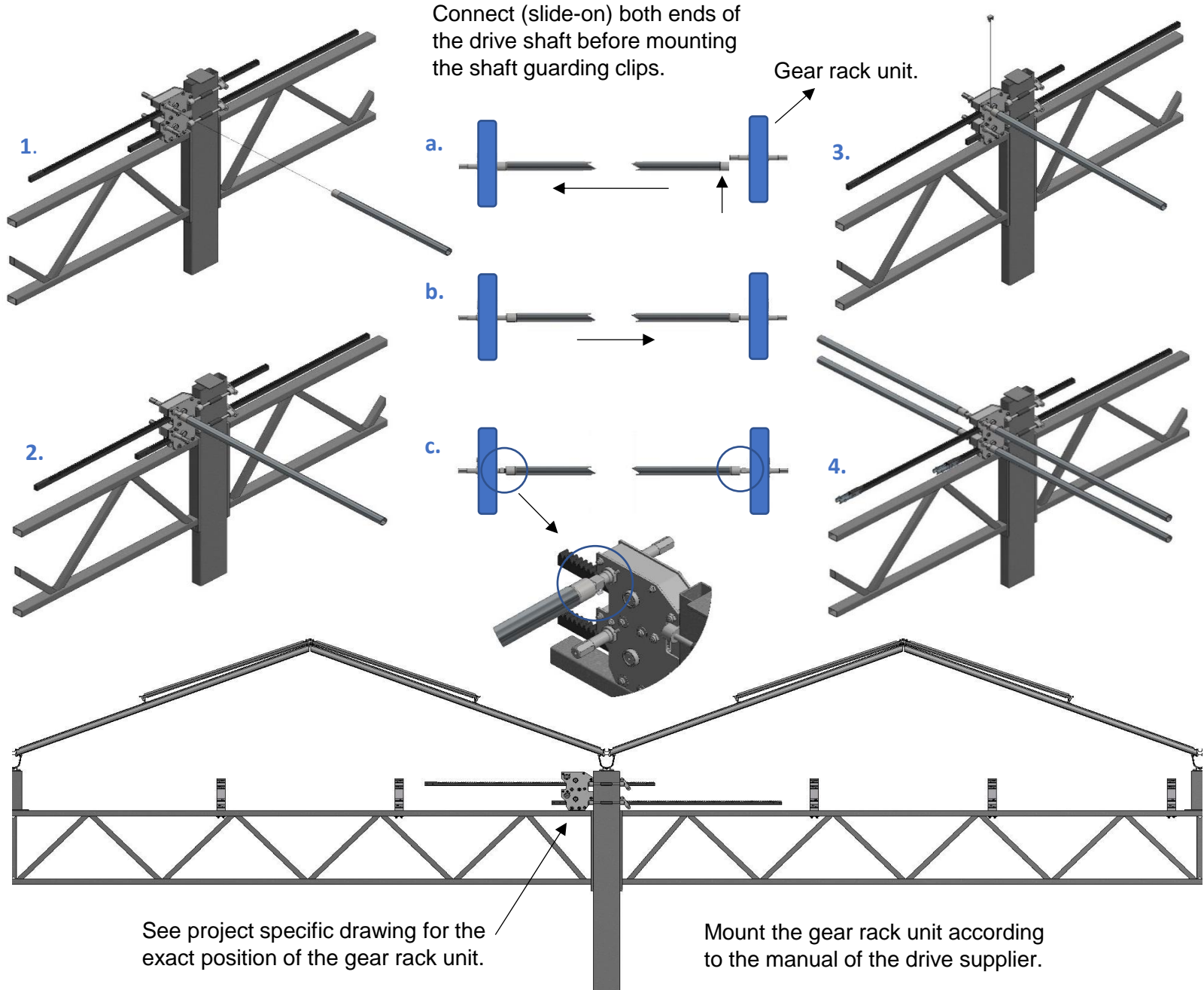



50.15.--     $\varnothing 27 \times 1,5 \text{ mm}$   
 50.20.--     $\varnothing 32 \times 1,5 \text{ mm}$   
 50.22.--     $\varnothing 32 \times 1,9 \text{ mm}$   
 ↑  
 (Length center to center)

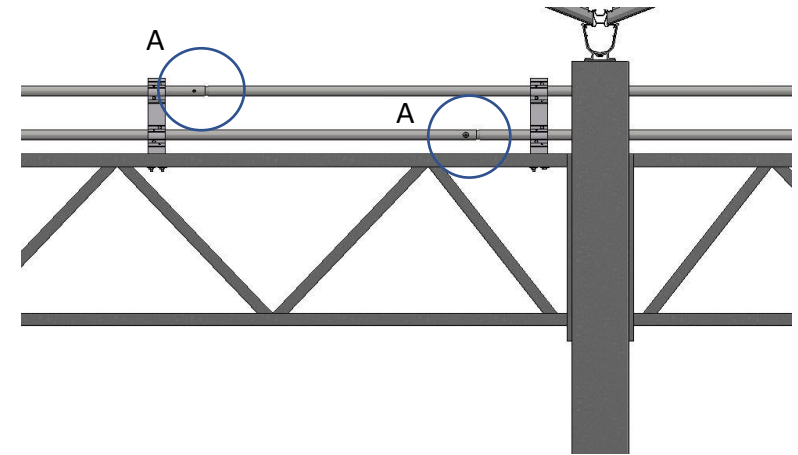
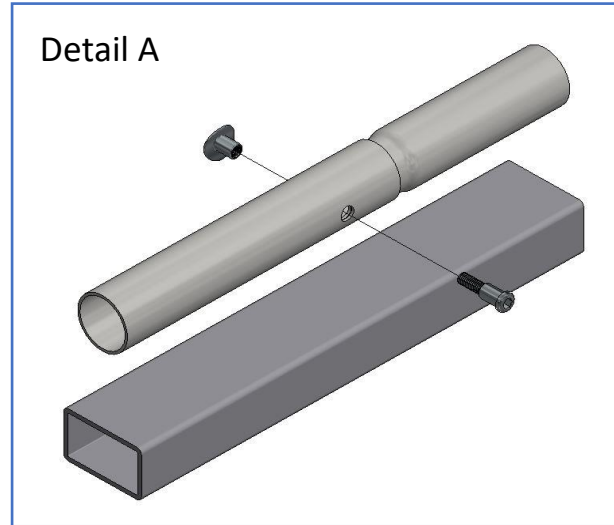

Note: The length of the push-pull tubes are project specific.

Note: Coupling positions are an indication.

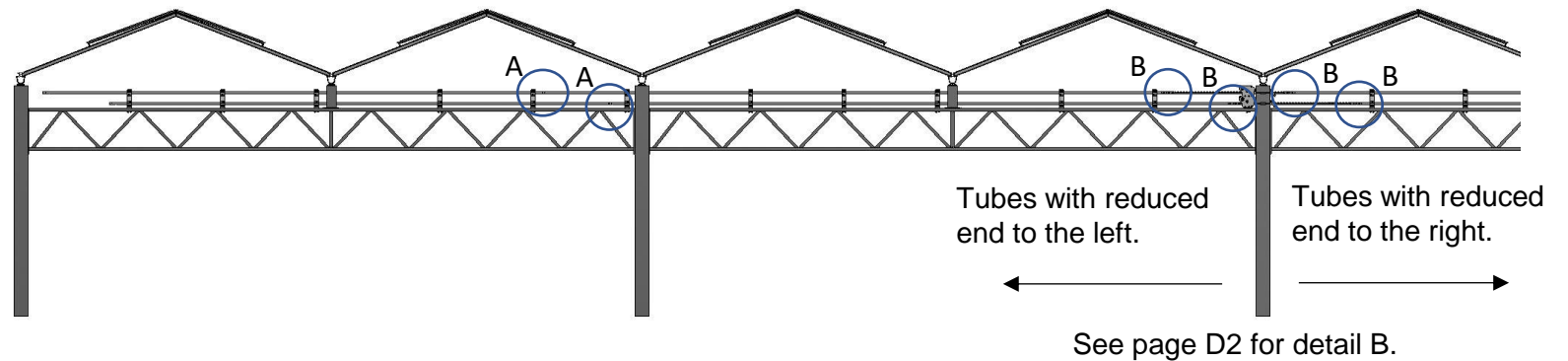





55.40.40

Ø27 M8x40

55.40.45

Ø32 M8x45



55.40.00

M8

Detail B

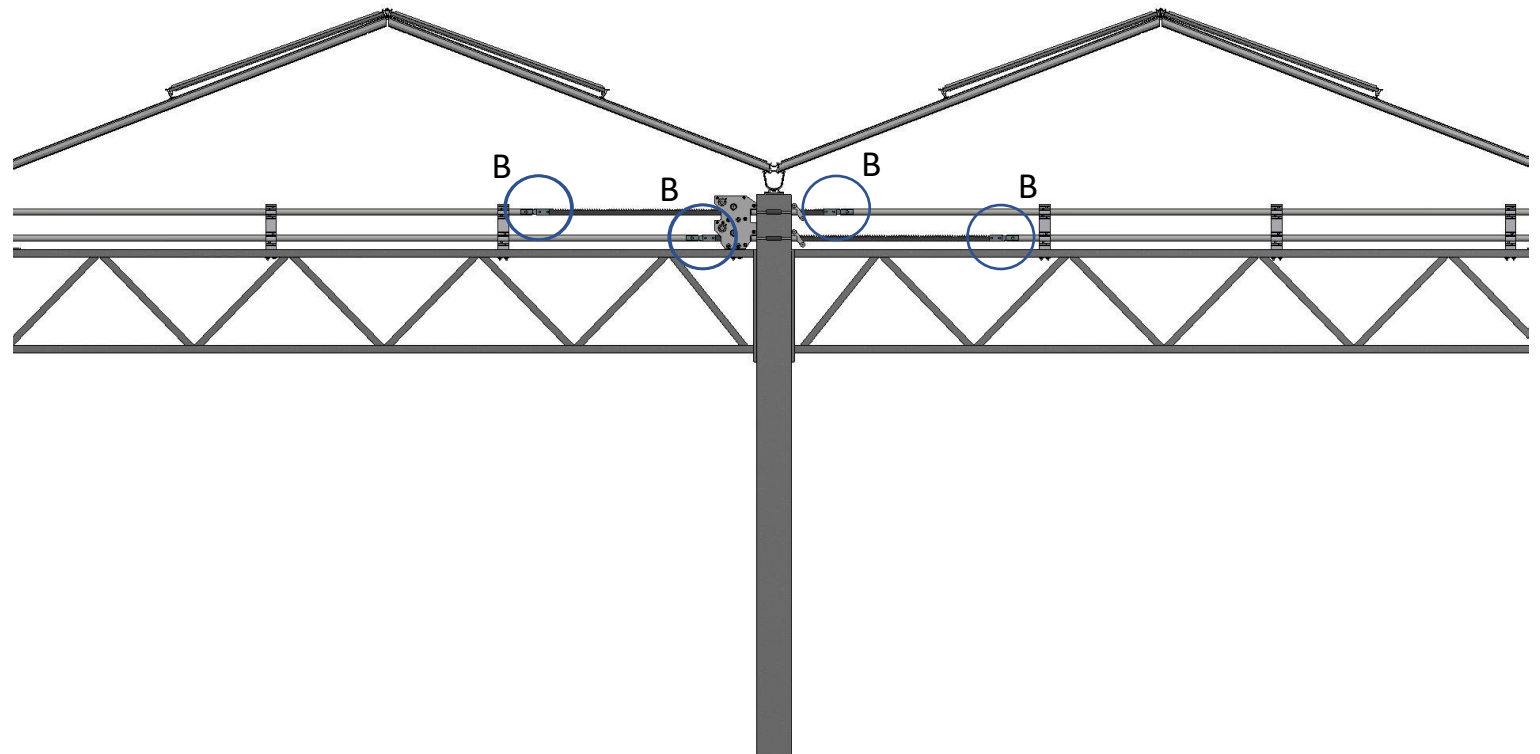
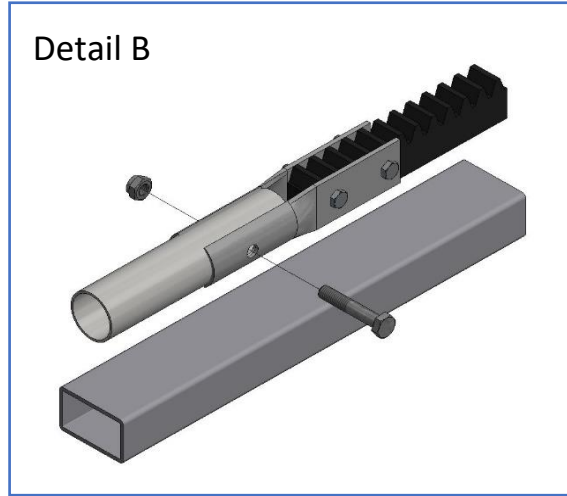

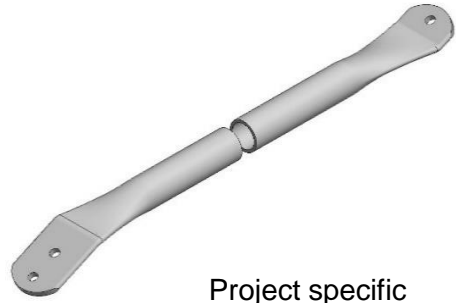

Project specific



41.16.21



56.30.40 M6x40



56.30.00 M6



Detail A

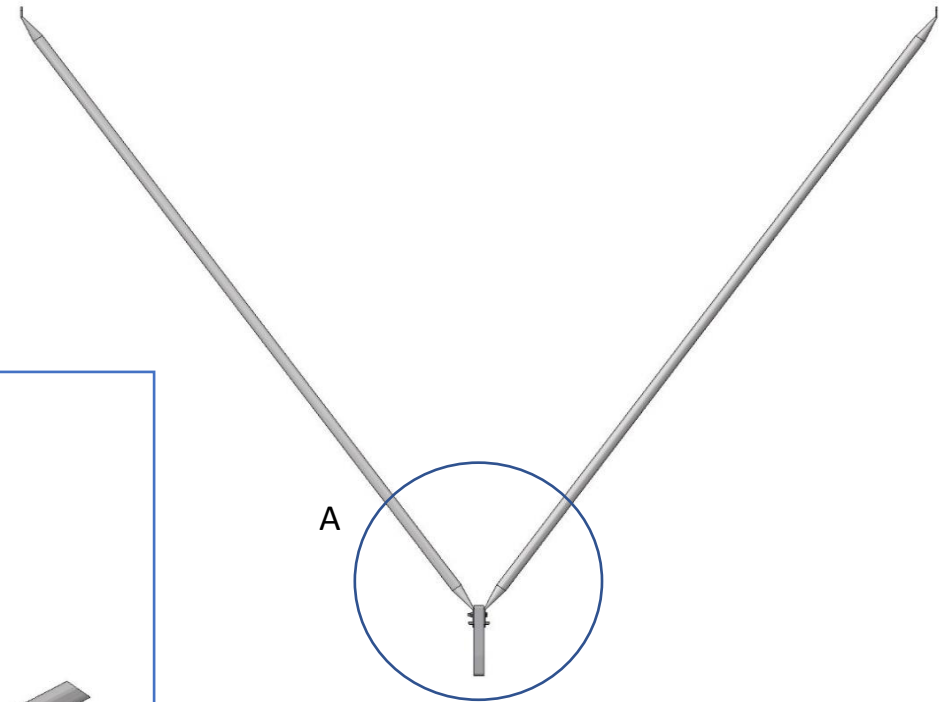

A

Note: See also the project specific drawing for the assembly of the push rod.



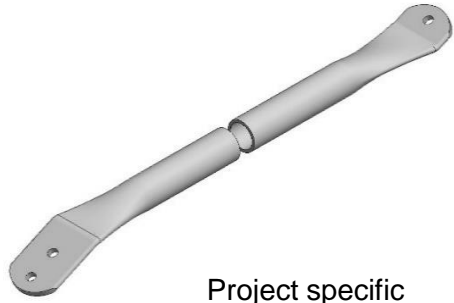

Project specific



41.16.30



41.16.32



56.30.55 M6x55



56.30.00 M6

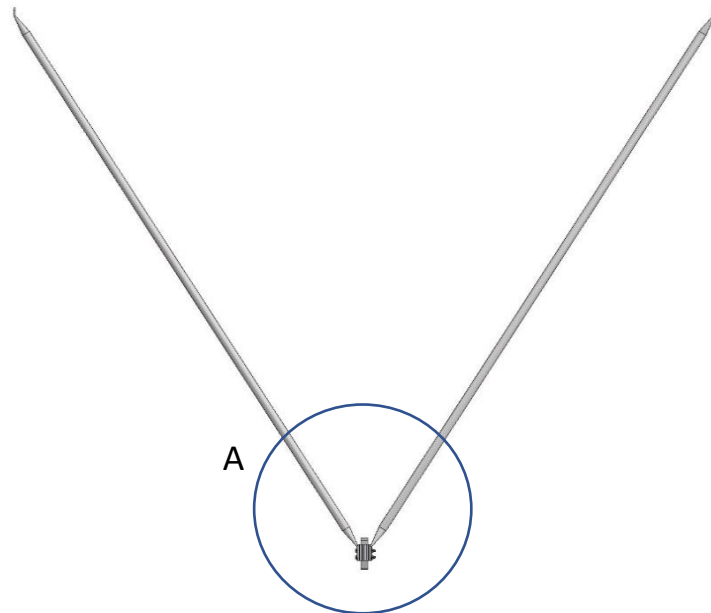
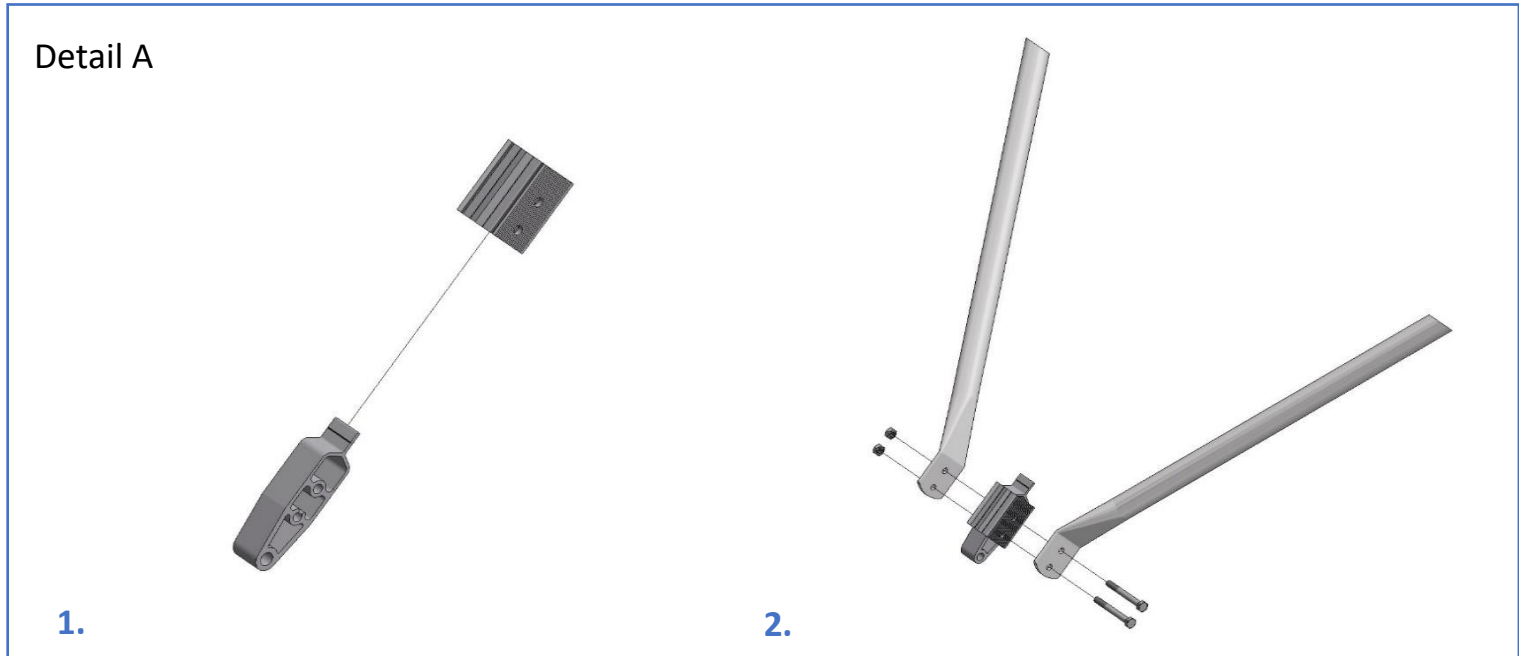

Note: See also the project specific drawing for the assembly of the push rod.

# ▶ Push Rods - First Row - Upper Push Rod Assembly

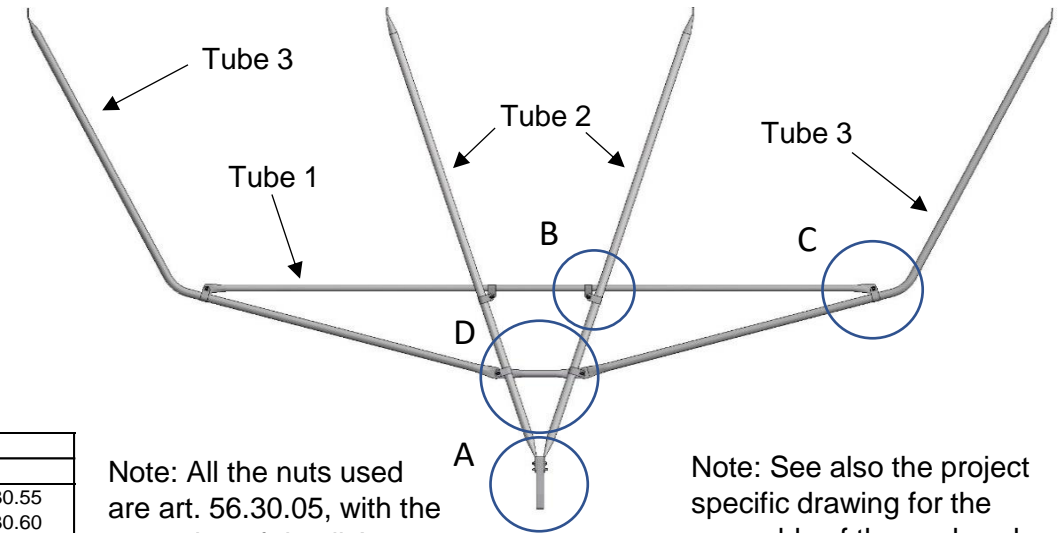
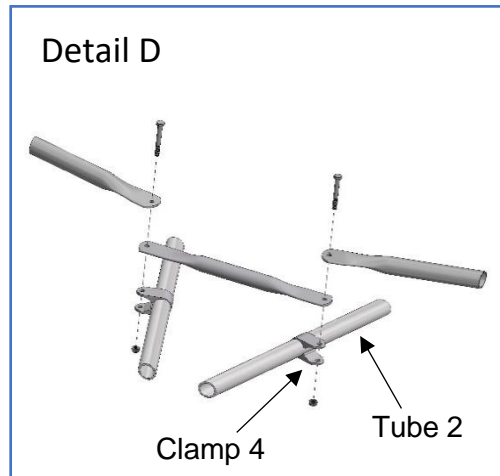
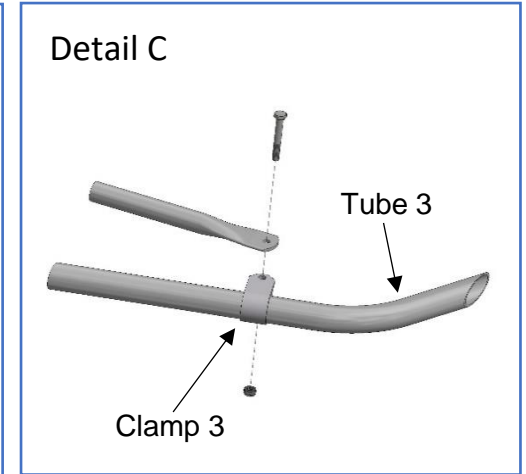
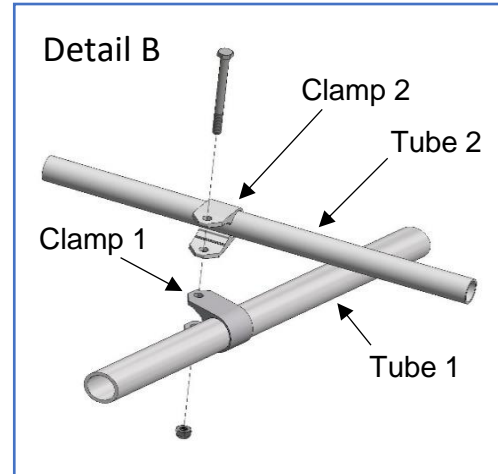
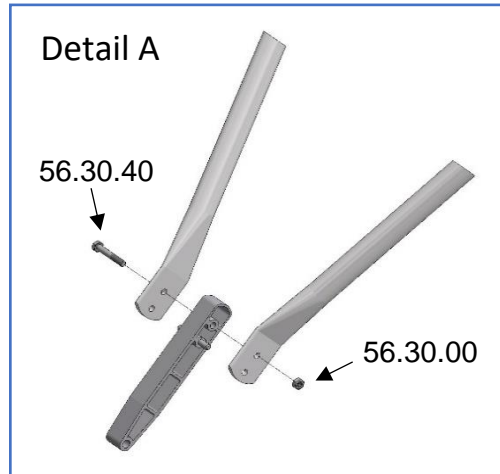
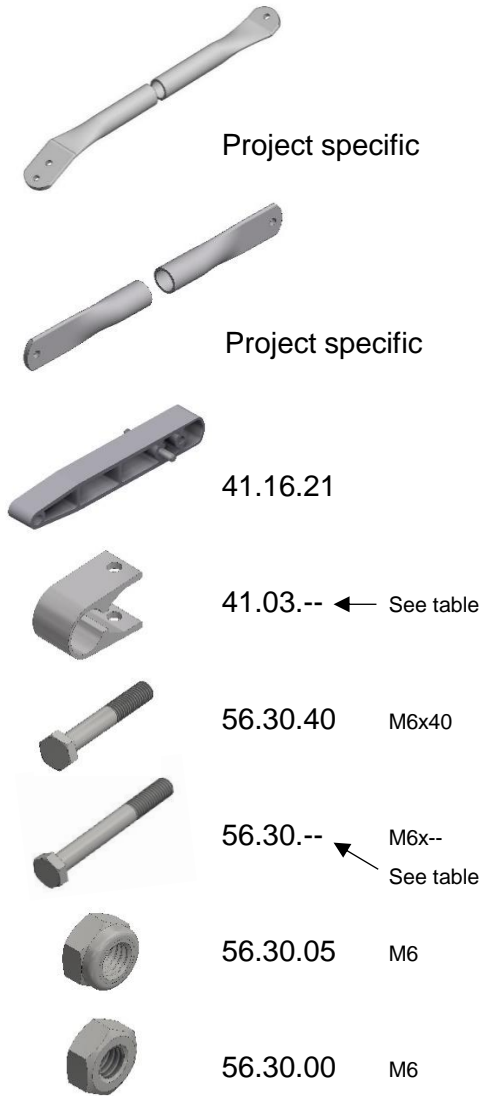

Note: All the nuts used are art. 56.30.05, with the exception of detail A.

Note: See also the project specific drawing for the assembly of the push rod.

Detail B				
Tube 1	Tube 2	Clamp 1	Clamp 2	Bolt
Ø19	Ø19	41.03.10	41.03.10	56.30.55
Ø19	Ø22	41.03.10	41.03.17	56.30.60
Ø19	Ø23,5	41.03.10	41.03.20	56.30.55
Ø19	Ø25	41.03.10	41.03.20	56.30.65
Ø22	Ø22	41.03.17	41.03.17	56.30.70
Ø22	Ø23,5	41.03.17	41.03.20	56.30.65
Ø22	Ø25	41.03.17	41.03.20	56.30.70
Ø23,5	Ø23,5	41.03.20	41.03.20	56.30.60
Ø23,5	Ø25	41.03.20	41.03.20	56.30.70
Ø25	Ø25	41.03.20	41.03.20	56.30.80

Detail C		
Tube 3	Clamp 3	Bolt
Ø19	41.03.10	56.30.35
Ø22	41.03.17	56.30.45
Ø23,5	41.03.20	56.30.40
Ø25	41.03.20	56.30.45

Detail D		
Tube 2	Clamp 4	Bolt
Ø19	41.03.10	56.30.40
Ø22	41.03.17	56.30.50
Ø23,5	41.03.20	56.30.45
Ø25	41.03.20	56.30.50

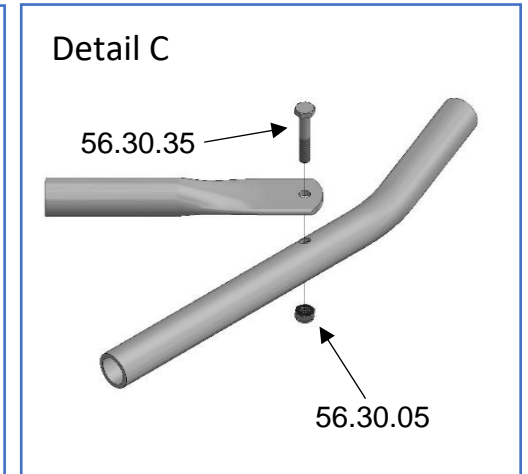
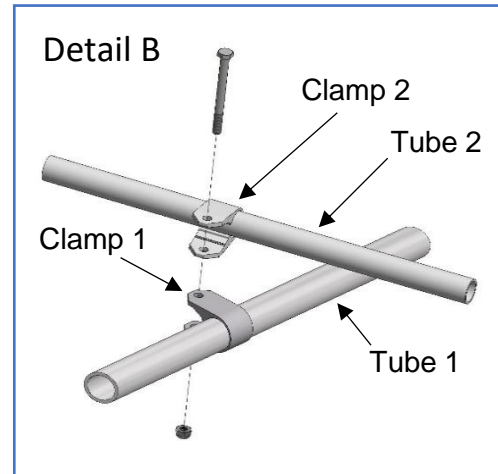
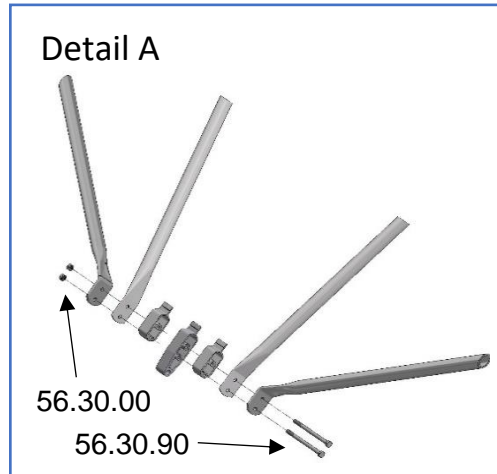

Note: All the nuts used are art. 56.30.05, with exception of detail A.

Detail B				
Tube 1	Tube 2	Clamp 1	Clamp 2	Bolt
Ø19	Ø19	41.03.10	41.03.10	56.30.55
Ø19	Ø22	41.03.10	41.03.17	56.30.60
Ø19	Ø23,5	41.03.10	41.03.20	56.30.55
Ø19	Ø25	41.03.10	41.03.20	56.30.65
Ø22	Ø22	41.03.17	41.03.17	56.30.70
Ø22	Ø23,5	41.03.17	41.03.20	56.30.65
Ø22	Ø25	41.03.17	41.03.20	56.30.70
Ø23,5	Ø23,5	41.03.20	41.03.20	56.30.60
Ø23,5	Ø25	41.03.20	41.03.20	56.30.70
Ø25	Ø25	41.03.20	41.03.20	56.30.80

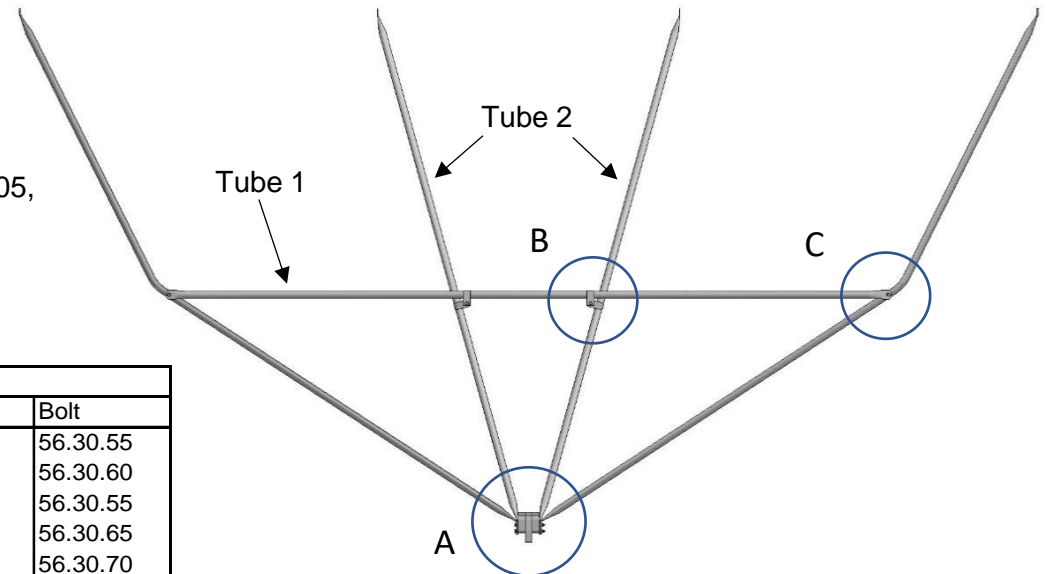

Note: See also the project specific drawing for the assembly of the push rod.



53.11.30



53.11.40

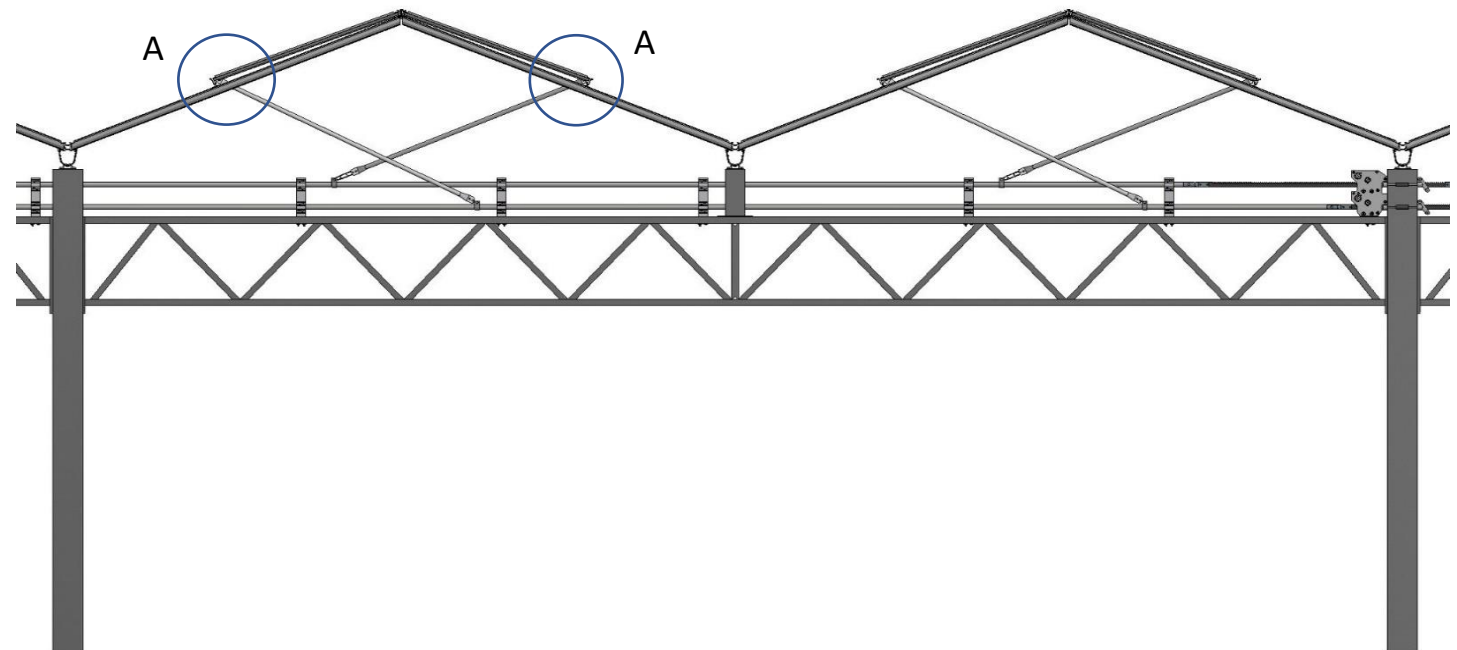
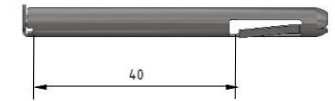
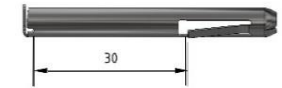
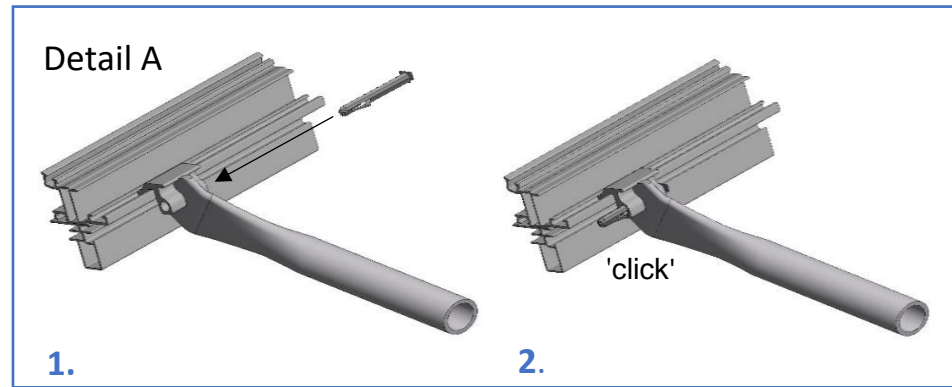

# ▶ Mounting of ValkStabiMax to the Clamp



41.10.40     $\varnothing 27$   
41.11.40     $\varnothing 32$



53.40.55    M8x55



56.40.00    M8

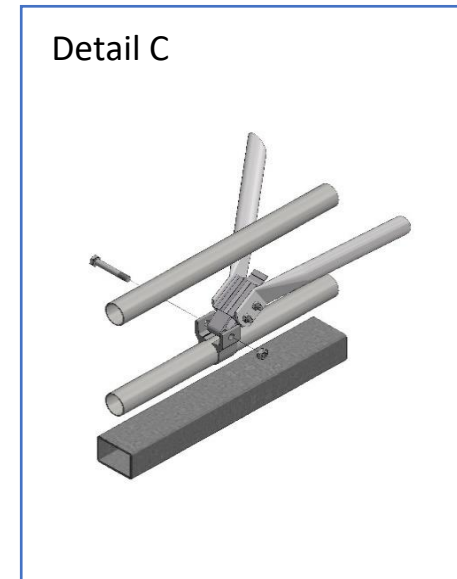
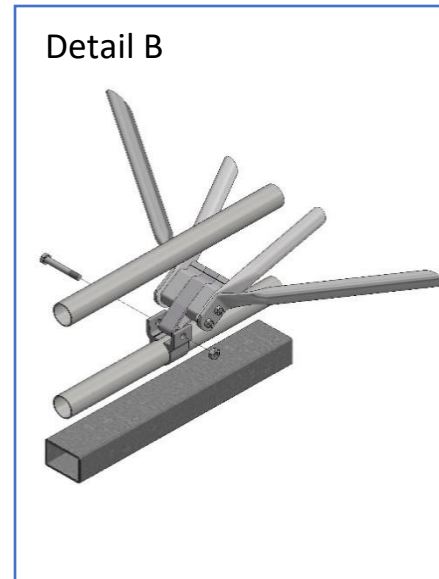

Note: Mount the head side of the bolt at the package side of the screen.

